

IMPORTANT

Failure to properly assemble according to installation instructions could result in loss of warranty.

Hardware box contains all necessary components required for assembly:

Cable Trough Jumpers (1 long and 1 short per table)

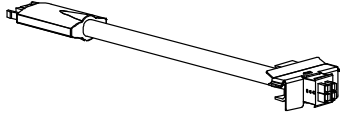

Power Support Plate

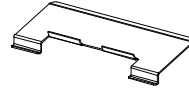

Power Bezel

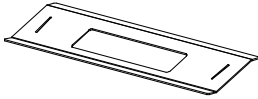

Power H Connector

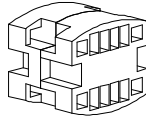

Power Receptacle

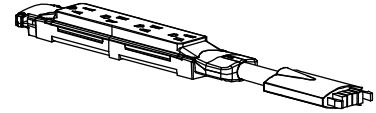

Support Plate Install

Ensure that table top is in the flipped up position so the cable channel is fully exposed.

Install the power support plate centered below grommet door in work surface. The lower portion of the plate will hook into the forward groove in the bottom of the cable channel.

Once engaged in groove apply pressure to rear edge of support plate to snap it into the lower groove in the rear wall of the cable channel.

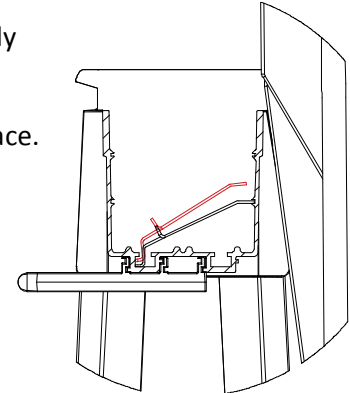

Note: Image is shown in cross section

Jumper and Receptacle Unit Install

The electrical jumpers for the Skill tables will come with a harness pre-installed on them. To install the jumpers in the cable channel, angle the harness slightly and slide into lower grooves in channel walls.

Push the harness to the end of the channel and apply pressure to one side of harness to cam the unit into place.

Repeat this for both jumpers on each table.

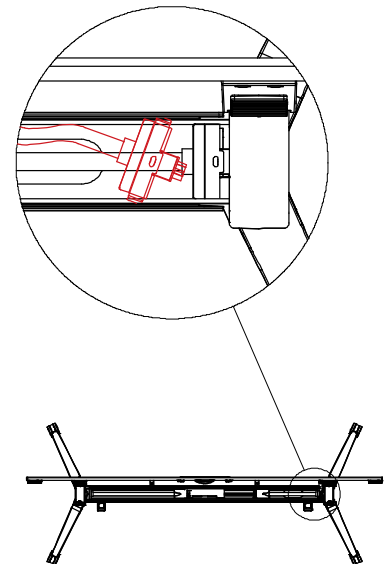

Place power receptacle on top of support plate with the whip positioned so it is coming out the right hand side of the unit.

Plug the jumper on the left hand end of the table into the end of the power receptacle

Connect the power h connector to the whip connected to the power receptacle

Connect the jumper on the right hand end of the table to the power h connector, preferably in the upper slot.

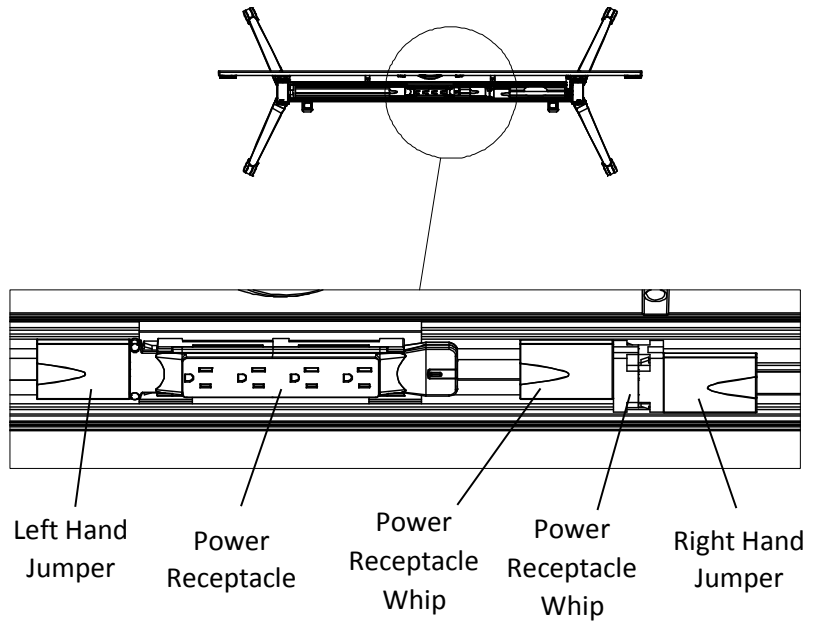

Power Bezel Install

To install the power bezel hook the front edge into the lower groove in the front wall of the cable channel.

Note: orient the power bezel as shown for proper installation.

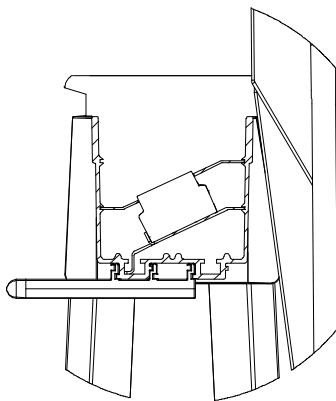
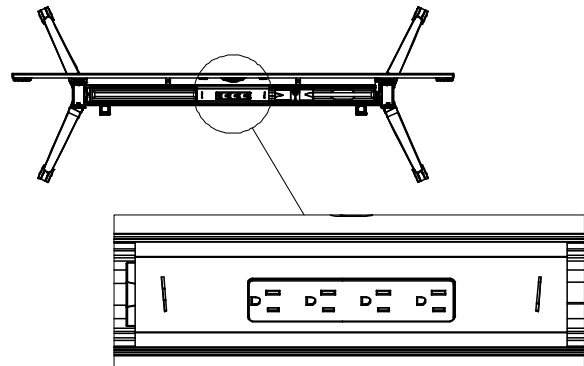

Note: Image is shown in cross section

Aligning the power receptacle unit with the large rectangular cutout, apply pressure along the rear edge of the bezel to snap into the upper groove in the rear wall of the cable channel.

Infeed Install for Hardwire Power System

This step is only applicable to tables which receive a power infeed.

Connect the 7" jumper to the power H connector installed previously in the cable channel.

Connect infeed to the 7" jumper. Depending on table length infeed can exit through a slot in the bottom of the cable channel or out the end of the channel to drop to the floor.

If the 20A plug style infeed has been specified, install the smart infeed box mounts to the underside of the cable channel as shown and when positioned as desired, lock in place with provided set screws.

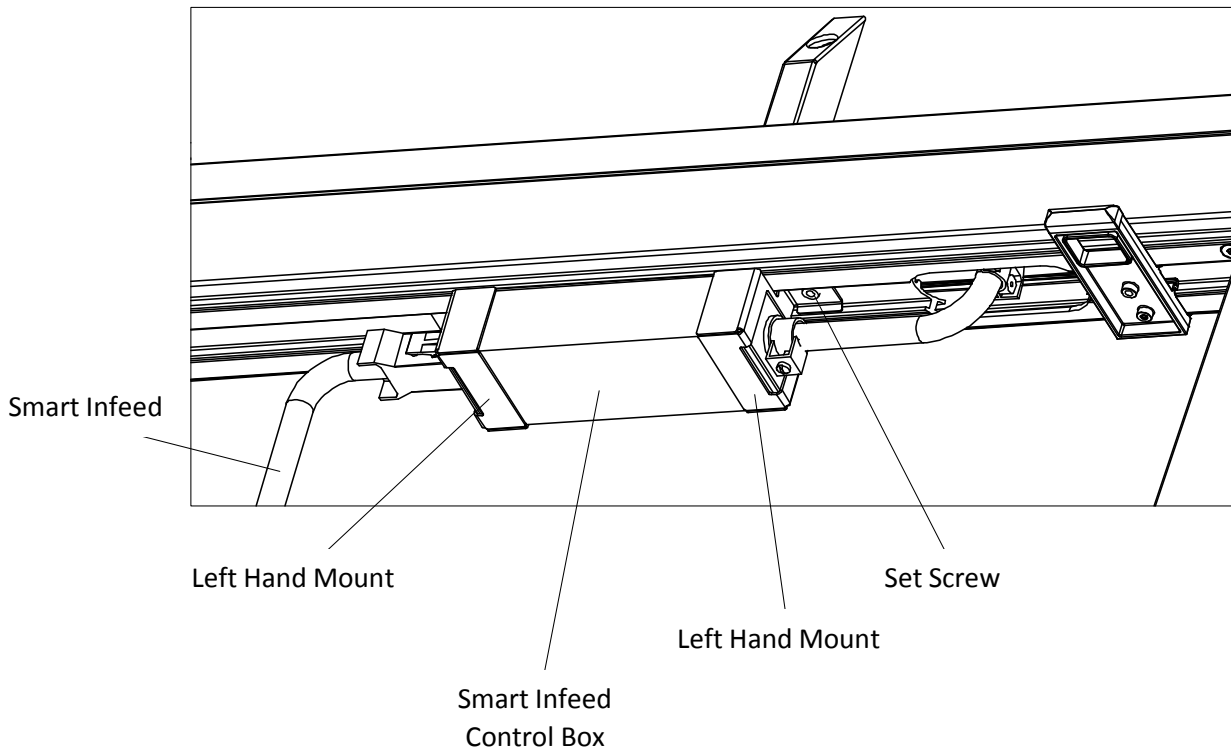

Note: If the quick connect floor plate has been specified it must be installed in the floor by a licensed electrician according to local electrical codes.

Note: if the hardwire infeed has been specified it must be hardwired into the building by a licensed electrician according to local electrical codes.

Note: Damage incurred during installation is not warranted.

IMPORTANT

Failure to properly assemble according to installation instructions could result in loss of warranty.

Hardware box contains all necessary components required for assembly:

Corded Power Box

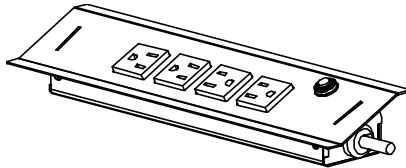

Velcro Strap

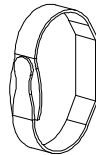

Power Unit Install

Ensure that table top is in the flipped up position so the cable channel is fully exposed.

Set power box into channel centered below the grommet door in the work surface.

Hook front edge of unit into the lower groove in the front wall of the cable channel, apply pressure along rear edge of unit to snap into the upper groove on the rear wall of the channel.

Tie up excess cord inside cable channel using provided Velcro strap.

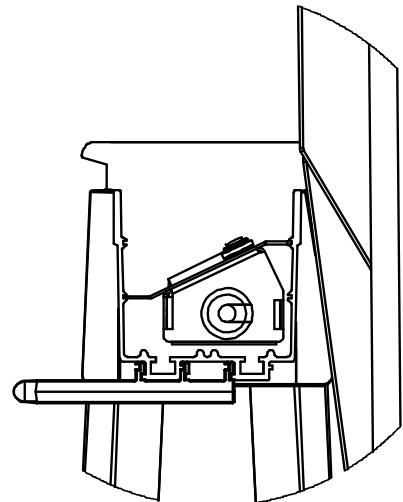

Note: Image is shown
in cross section

Note: Damage incurred during installation is not warranted.

IMPORTANT

Failure to properly assemble according to installation instructions could result in loss of warranty.

Hardware box contains all necessary components required for assembly:

Data Mounts (Pair)

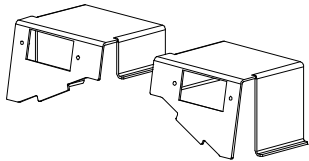

Power Unit Install

Align data mount with slot in power unit face plate. Apply pressure to top of data mount to snap into grooves in walls of cable channel.

Data mounts are designed to accept 1 Extron MAAP plate each.

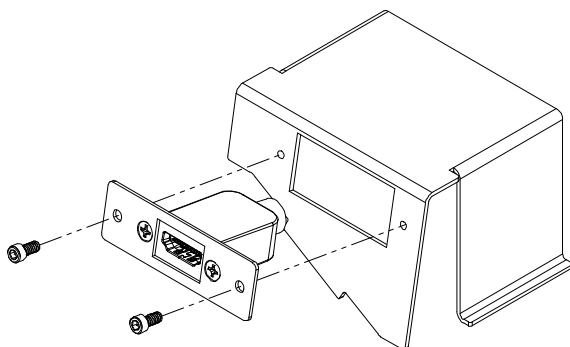
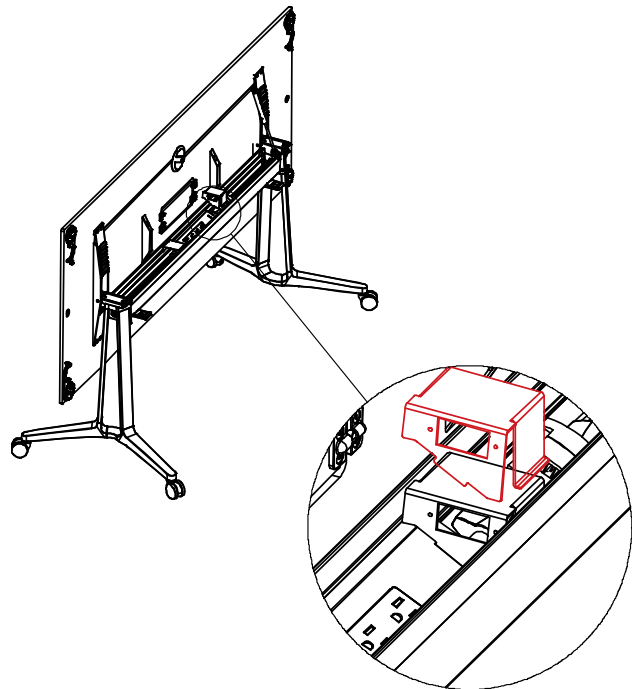

To install MAAP plates, align holes in the plate with the threaded holes in the data mount. Using the screws included with the MAAP plate secure the plate to the data mount.

Note: Damage incurred during installation is not warranted.